

Jan 27 (cont)

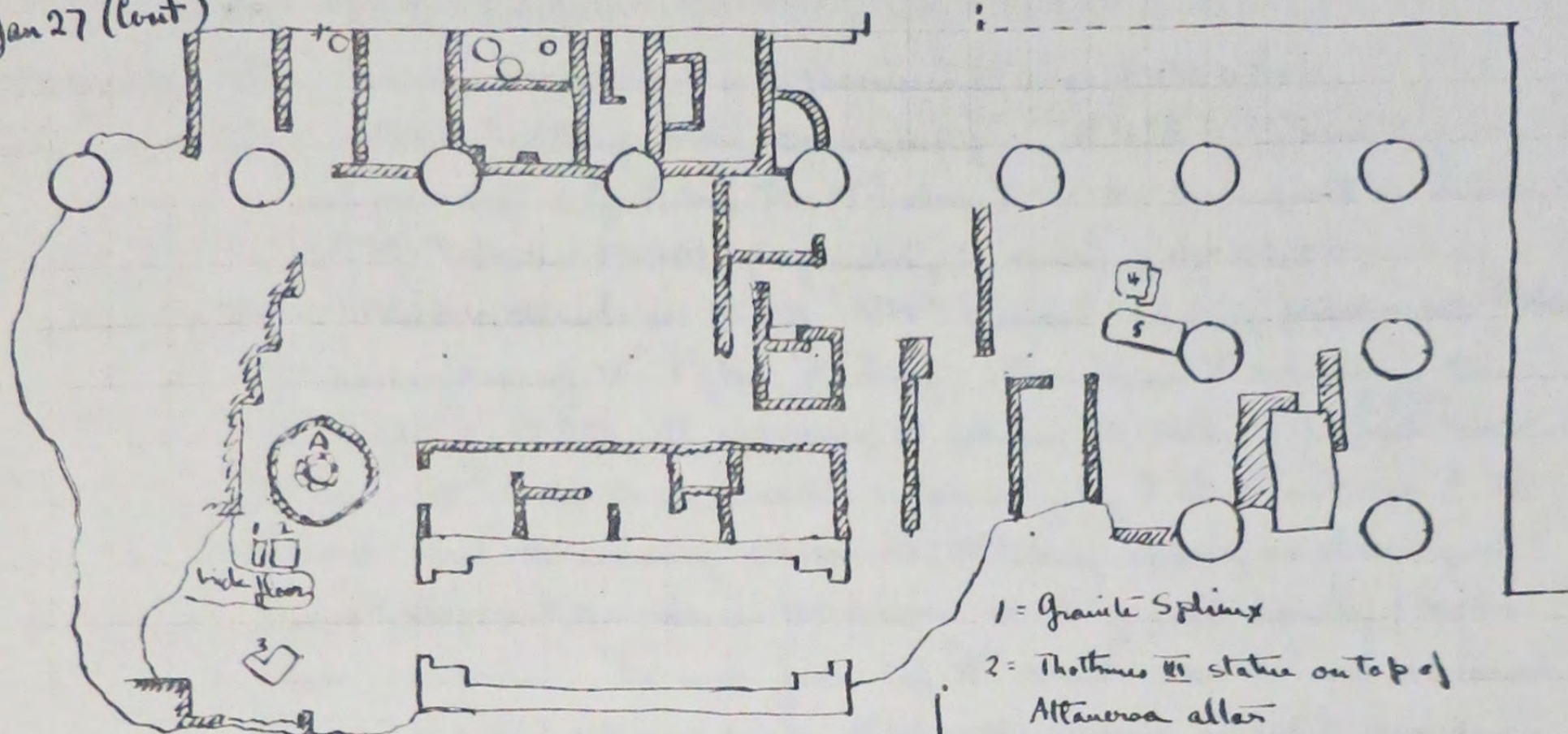
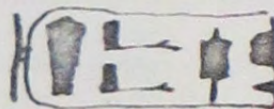

A large burnt brick well coping, with inside a roughly stone lined well of small diameter, just big enough for a man to go down. This we are now clearing. At x in N well one reused red sandstone block with part of a cartouche in sunk relief. The characters are thus:  From debris in room "S" of x a mould bearing impression of a figure of Isis. The mould is of a badly backed red brick, with some black patches L. 15.5, W. 8.5.

I continued on map of B 300 and on object register.

Another wire received from Halfa re the Fleurent food supplies which are still being held by Customs there for information as to value and nature of contents. Send Dr Reimer another wire on the subject.

Jan 28th - Wednesday 86 locals. 1/2 day.

44th Day.

Very cold & windy.

- (1) Work continued in depression in area B 503 Ex 1 as previously. Down a little over 3 meters from surface. A few crude mud jar sealings without seal impressions from this work today.
- (2) Work continued in Room B 501 "NW" part. Continued clearing well A at which progress is slow owing to cramped working space in the shaft. Continued clearing "westward" towards 1st Pylon "N" of A and to "N" wall of room. The 5th column from door in "N" face, and the 1st column south therefrom are now clear, and I am inclined to the supposition that for the space of 5 columns the central portion of the room had only one row at "N" + "S" and was open in the middle.

Owing to the cold and high wind, the locals were very slow this morning, and it was thought best to stop the work at noon, making at a half day.

Jan 29th - Thursday, Windy day - rest for men.